

## Datasheet

# HP Officejet Pro 6230 ePrinter



Professional color documents and eye-catching marketing materials for business—for up to 50% less cost per page than lasers.<sup>1</sup> This ePrinter is designed for productivity and mobile printing to keep business moving—at work, home, or on the go.<sup>2</sup>



**ISO speeds:** Up to 18 ppm black, Up to 10 ppm color

**Display:** Button and LED control panel

**Standard connectivity:** 1 USB 2.0; 1 Ethernet; 1 Wireless 802.11b/g/n

**Paper handling:** 225-sheet input tray; 60-sheet output tray

**Duty cycle:** Up to 15,000 pages

**Borderless:** Yes, up to 8.5 x 11 in (US Letter), 210 x 297 mm (A4)

### Professional color for less than lasers<sup>1</sup>

- Look professional with every page, using Original HP pigment inks for vibrant, durable prints.<sup>3</sup>
- Count on a better value for frequent printing with Original HP high-yield individual ink cartridges.<sup>4</sup>
- Set the pace for success—with speeds up to 18 pages per minute (ppm) black-and-white and 10 ppm color.<sup>5</sup>
- Save up to 50% on paper with automatic two-sided printing of documents and borderless color brochures.

### Print on your terms

- Print wirelessly from your smartphone, tablet, and notebook—no router or access to local network required.<sup>6</sup>
- Print photos, documents, and more when you're on the go—from virtually anywhere—using HP ePrint.<sup>7</sup>
- Easily connect to your local network and the Internet, wirelessly or using the 10/100 Ethernet port.<sup>8</sup>
- Boost productivity, with the free HP All-in-One Printer Remote mobile app for high-quality mobile scanning.<sup>9</sup>

### Productivity features to keep business rolling

- Turn up the print volume. Reload paper less often and handle large print jobs, using the 225-sheet paper tray.
- Depend on a printer with an up to 15,000-page monthly duty cycle—the perfect fit for reliable color printing.
- Lock in quality. For fast-drying results that resist fading for decades, HP recommends ColorLok<sup>®</sup> paper.<sup>3</sup>



<sup>1</sup> Cost-per-page (CPP) claim compares the majority of multi-pass color laser printers <\$300 USD as of February 2014, based on market share as reported by Q4 2013 IDC. CPP for laser supplies are based on published specifications of the manufacturers' highest-capacity cartridges. HP Officejet Pro CPP based on HP 934XL/935XL ink cartridges estimated street price, published yield, and continuous printing. Actual prices may vary. Actual yields may vary based on images printed and other factors. For more information, see <http://www.hp.com/go/learnaboutsupplies>.<sup>2</sup> Local printing requires mobile device and printer to be on the same wireless network or have a direct wireless connection. Wireless performance is dependent on physical environment and distance from access point. Wireless operations are compatible with 2.4 GHz operations only. Remote printing requires an Internet connection to an HP web-connected printer. App or software and HP ePrint account registration may also be required. Wireless broadband use requires separately purchased service contract for mobile devices. Check with service provider for coverage and availability in your area. See <http://www.hp.com/go/mobileprinting> for more details.<sup>3</sup> Fade resistance based on paper-industry predictions for acid-free papers and Original HP inks; colorant stability data at room temperature based on similar systems tested per ISO 11798 and ISO 18909. Water resistance based on HP internal testing, using paper with the ColorLok<sup>®</sup> logo.<sup>4</sup> Based on HP 934XL High Yield Black Original Ink Cartridges and HP 935XL High Yield color ink cartridges. High-yield ink cartridges not included; purchase separately. For more information, see <http://www.hp.com/go/learnaboutsupplies>. Value compared with estimated street price and average page yield of standard-yield HP 934/935 ink cartridges. Actual pricing may vary.<sup>5</sup> After first set of ISO test pages. For more information, see <http://www.hp.com/go/printerclaims>.<sup>6</sup> Mobile device must be connected directly to the printer's wireless network prior to printing. Depending on mobile device, an app or driver may also be required. Wireless performance is dependent on physical environment and distance from access point.<sup>7</sup> Check your compatible device's official app store for HP ePrint app download availability. Requires an Internet connection to an HP ePrint-enabled printer. Printer requires ePrint account registration. App or software may be required. Wireless operations are compatible with 2.4 GHz operations only. Print times and connection speeds may vary. Wireless broadband use requires separately purchased service contract for mobile devices. Check with service provider for coverage and availability in your area. Learn more at <http://www.hp.com/go/mobileprinting>.<sup>8</sup> Wireless performance is dependent on physical environment and distance from access point. Wireless operations are compatible with 2.4 GHz routers only.<sup>9</sup> Mobile device requires wireless access point and an Internet connection. Compatible with iPhone<sup>®</sup> 4 and later, iPad<sup>®</sup> 4th generation, iPad mini<sup>™</sup>, iPad Air<sup>™</sup>, and iPod<sup>®</sup> 5G using iOS 7 or later, and mobile devices using Android<sup>™</sup> 4.0.x or later. Features controlled may vary by mobile device operating system. Scan/copy control requires mobile device and printer be on the same wireless network or through wireless direct connection to printer. For mobile scanning, device camera requires 5 megapixels or greater with autofocus capability.

## HP Officejet Pro 6230 ePrinter Specifications Table

<b>Print Speed</b>	<b>Black (ISO):</b> Up to 18 ppm; <b>Color (ISO):</b> Up to 10 ppm <sup>1</sup> ; <b>First Page Out Black:</b> As fast as 14 sec; <b>First Page Out Color:</b> As fast as 17 sec; <b>Black (Draft):</b> Up to 29 ppm; <b>Color (Draft):</b> Up to 24 ppm
<b>Print Resolution</b>	<b>Black (best):</b> Up to 600 x 1200 dpi; <b>Color (best):</b> Up to 600 x 1200 dpi
<b>Print Technology</b>	HP Thermal Inkjet
<b>Print Cartridges Number</b>	4 (1 each black, cyan, magenta, yellow)
<b>Borderless Printing</b>	Yes, up to 8.5 x 11 in (US letter), 210 x 297 mm (A4)
<b>Standard Print languages</b>	HP PCL 3 GUI, HP PCL 3 Enhanced
<b>Printer Smart Software Features</b>	Orientation: Portrait/Landscape; Print on Both Sides: None/Flip on Long Edge/Flip on Short Edge; Pages per Sheet: 1, 2, 4, 6, 9, 16 (i.e. N-up printing); Quality Settings: Draft/Normal/Best; Color: Black & White/Color; Printing Shortcuts; Print in Grayscale: Off/High Quality Grayscale/Black Ink Only; Pages Per Sheet Layout: Right then Down/Down then Right/Left then Down/Down then Left; Borderless Printing: Off/On; HP Real Life Technologies: Off/On; Booklet: None/Booklet-LeftBinding/Booklet-RightBinding; Pages to Print: Print All Pages/Print Odd Pages Only/Print Even Pages Only; Print in Max DPI: No/Yes; Page Borders: Off/On
<b>Printer Management</b>	No
<b>Standard Connectivity</b>	1 USB 2.0; 1 Ethernet; 1 Wireless 802.11b/g/n
<b>Network Capabilities</b>	Standard (built-in Ethernet, WiFi 802.11b/g/n)
<b>Network Ready</b>	Standard (built-in Ethernet, WiFi 802.11b/g/n)
<b>Wireless Capability</b>	Yes, built-in WiFi 802.11b/g/n
<b>Mobile Printing Capability</b>	HP ePrint, Apple AirPrint™ <sup>2</sup>
<b>Memory</b>	<b>Standard:</b> 256 MB; <b>Maximum:</b> 128 MB DDR3, 2 KB EEPROM, 128 MB SPI Flash
<b>Processor Speed</b>	500 MHz
<b>Duty Cycle</b>	<b>Monthly, letter:</b> Up to 15,000 pages
<b>Recommended Monthly Page Volume</b>	200 to 800 (print) <sup>3</sup>
<b>Media Types Supported</b>	Plain paper, HP Photo Papers, HP Matte Brochure or Professional Paper, HP Matte Presentation Paper, HP Glossy Brochure or Professional Paper, Other photo inkjet papers, Other matte inkjet papers, Other glossy inkjet papers, Inkjet hagaki, Photo hagaki, Thick plain paper
<b>Media Weight Supported</b>	Plain paper: 16 to 28 lb, Bond
<b>Media Sizes Supported</b>	A4, A5, A6, B5 (JIS), 6 x 8 in, Executive, Index card 3.5 x 5 in, Index card 4 x 6 in, Index card 5 x 8 in, Index card A4, Index card Letter, 3 x 5 in, 4 x 6 in, 5 x 7 in, 13 x 18 cm, 8 x 10 in, 10 x 15 cm, L, Photo 2L, 8.5 x 13 in, Legal, Letter, Statement, Ofuku Hagaki, Japanese Postcard, Envelope #10, Envelope A2, Envelope C5, Envelope C6, Envelope DL, Envelope Monarch, Card Envelope 4.4 x 6 in, JIS Chou #3, JIS Chou #4
<b>Media Sizes Custom</b>	3 x 5 in to 8.5 x 14 in (Simplex), 3 x 5.5 in to 8.5 x 12.2 in (Auto Duplex)
<b>Paper Handling</b>	225-sheet input tray; 60-sheet output tray; <b>Duplex Options:</b> Automatic (standard); <b>Envelope Feeder:</b> No; <b>Standard Paper Trays:</b> 1; <b>Input Capacities:</b> Up to 225 sheets; <b>Output Capacities:</b> Up to 60 sheets
<b>What's in the box</b>	<b>E3E03A</b> HP Officejet Pro 6230 ePrinter; Power cord; Host ink cartridges; User Guide; Set up poster
<b>Replacement Cartridges</b>	HP 934XL Black Print Cartridge; HP 935XL Cyan Print Cartridge; HP 935XL Magenta Print Cartridge; HP 935XL Yellow Print Cartridge

<b>Product Dimensions</b>	<b>W x D x H:</b> 18.27 x 15.16 x 5.73 in; <b>Maximum:</b> 18.27 x 22.05 x 5.73 in
<b>Product Weight</b>	11.22 lb
<b>Warranty Features</b>	One-year limited hardware warranty; 24-hour, 7 days a week phone support
<b>Energy Efficiency Compliance</b>	ENERGY STAR® qualified
<b>Control Panel</b>	Buttons (Power, Cancel, Resume, Information, Wireless, Wifi-Direct, ePrint, Media Size) LEDs (Ink color for K, M, C, Y, Resume, Wireless, Wifi-Direct, ePrint, Media size)
<b>Display Description</b>	Button and LED control panel
<b>Software Included</b>	HP Printer Software, Google Toolbar, HP Update, Shop for Supplies Online
<b>Compatible Operating Systems</b>	Windows 8.1 (32-bit and 64-bit), Windows 8 (32-bit and 64-bit), Windows 7 (32-bit and 64-bit), Windows Vista (32-bit and 64-bit), Windows XP (32-bit) (Professional and Home Editions); Mac OS X v 10.6, v 10.7, v 10.8 or v 10.9; Linux (For more information, see <a href="http://hplipopensource.com/hplip-web/index.html">http://hplipopensource.com/hplip-web/index.html</a> ).
<b>Compatible Network Operating Systems</b>	Windows 8.1 (32-bit and 64-bit), Windows 8 (32-bit and 64-bit), Windows 7 (32-bit and 64-bit), Windows Vista (32-bit and 64-bit), Windows XP (32-bit) (Professional and Home Editions); Mac OS X v 10.6, v 10.7, v 10.8 or v 10.9; Linux (For more information, see <a href="http://hplipopensource.com/hplip-web/index.html">http://hplipopensource.com/hplip-web/index.html</a> ). Operating System Support (Enterprise install only), Windows 2003 Server (32-bit and 64-bit, SP1 and SP2) (Standard Edition, Enterprise Edition), Windows 2003 Server R2 (32-bit and 64-bit) (Standard Edition, Enterprise Edition), Windows 2008 Server (32-bit and 64-bit, SP1 and SP2) (Standard Edition, Enterprise Edition), Windows 2008 Server R2 (64-bit) (Standard Edition, Enterprise Edition), Windows Server 2012
<b>Minimum System Requirements</b>	<b>PC:</b> Windows 7, 8, 8.1: 1 GHz 32-bit (x86) or 64-bit (x64) processor, 2 GB HD, Internet Explorer, CD-ROM/DVD or Internet, USB; Windows Vista: 800 MHz 32-bit (x86) or 64-bit (x64) processor, 2 GB HD, Internet Explorer, CD-ROM/DVD or Internet, USB; Windows XP SP3 (32-bit only): Intel Pentium® II, Celeron® or 233 MHz compatible processor, 750 MB HD, Internet Explorer 6, CD-ROM/DVD or Internet, USB; <b>MAC:</b> Mac OS X Lion, OS X Mountain Lion, OS X Mavericks: 1 GB HD, Internet, USB
<b>Power</b>	<b>Power Supply Type:</b> Internal; <b>Power Requirements:</b> Input voltage: 100 to 240 VAC (+/- 10%), 50/60 Hz (+/- 3 Hz); <b>Power Consumption:</b> 24 watts maximum, 3.3 watts (Active), 0.5 watts (Manual-Off), 1.16 watts (Sleep) <sup>4</sup>
<b>Acoustics</b>	<b>Acoustic Power Emissions:</b> Normal mode mono 6.8 B(A) color 6.4 B(A); <b>Acoustic Pressure Emissions:</b> 63 dB(A) (Draft printing Mono) ; 61 dB(A) (Normal printing Mono)
<b>Operating Environment</b>	<b>Operating Temperature Range:</b> 41 to 104°F; <b>Recommended Operating Temperature:</b> 59 to 86°F; <b>Storage Temperature Range:</b> -40 to 140°F; <b>Non-Operating Humidity Range:</b> 20 to 90% RH (non-condensing); <b>Operating Humidity Range:</b> 20 to 0% RH (non-condensing); <b>Recommended Humidity Operating Range:</b> 20 to 80% RH (non-condensing)
<b>HP Service and Support Options</b>	UZ381E - HP 2 Year Care Pack Business Priority Support with Next Business Day Exchange; UZ382E - HP 3 Year Care Pack Business Priority Support with Next Business Day Exchange; UZ383E - HP 4 Year Care Pack Business Priority Support with Next Business Day Exchange; U6M47E - HP 2 Year Care Pack Business Priority Support with Onsite Exchange; U6M48E - HP 3 Year Care Pack Business Priority Support with Onsite Exchange; U6M49E - HP 4 Year Care Pack Business Priority Support with Onsite Exchange

Learn more at [hp.com](http://hp.com)

<sup>1</sup> After first page; see <http://www.hp.com/go/inkjetprinter> for details. Print speed may vary depending on the type of output. <sup>2</sup> Supports Android 4.4,iOS 4.2 devices iPad®, iPhone® 4, iPhone® 3GS, iPod touch® 3rd and 4th generation capable of multi-tasking. Works with HP ePrint-enabled printers and all-in-ones. AirPrint™ and iOS 4.2 or later devices require an 802.11 wireless network connection to the printer. Wireless performance is dependent upon physical environment and distance from the access point. AirPrint and the AirPrint Logo are trademarks of Apple® Inc. iPad, iPhone, and iPod touch are trademarks of Apple® Inc., registered in the U.S. and other countries. Mobile ePrint app supported on all iOS, Android, and BB devices running OS 4.5 or later but prior to OS 10. <sup>3</sup> HP recommends that the number of pages per month of imaged output be within the stated range for optimum device performance, based on factors including supplies replacement intervals and device life over an extended warranty period. <sup>4</sup> Power requirements are based on the country/region where the printer is sold. Do not convert operating voltages. This will damage the printer and void the product warranty.



Product guide

# Stand out with affordable business printing



HP Officejet Pro 6230 ePrinter



July 2014

# Table of contents

- 3** Help your business grow
- 4** Product walk around
- 5** Product comparison
- 6** Top features at a glance
- 7** Professional colour for less than lasers<sup>1</sup>
- 8** Print on your terms
- 9** Productivity features to keep business rolling
- 10** Save resources without sacrificing performance

# Help your business grow

Impress customers and help your business grow with professional-quality colour documents and eye-catching marketing materials—for up to 50 percent lower cost per page than colour lasers.<sup>1</sup> Handle large printing jobs with the 225-sheet paper tray and automatic two-sided printing. Keep your business moving with easy mobile printing from work, home, or on the go.<sup>2</sup>

## Who can benefit?

This ePrinter is ideal for cost-conscious business customers looking to boost productivity and print high-quality colour documents at a low cost. Designed for hassle-free use, this ePrinter offers easy mobile printing<sup>2</sup> to help keep your business moving. Plus, this ENERGY STAR<sup>®</sup> qualified compact, reliable printer uses up to 50 percent less energy than colour lasers,<sup>3</sup> which can help reduce energy use and save money.



# Product walk around

- 1 Simple and easy-to-use control panel
- 2 Integrated automatic two-sided printing
- 3 Output tray up to 60 sheets
- 4 Input tray up to 225 sheets
- 5 500 MHz processor, 128 MB RAM
- 6 Power connection
- 7 Integrated 802.11b/g/n wireless networking
- 8 Ethernet network port for easy sharing
- 9 Hi-Speed USB 2.0 printing port



# Product comparison

The following table compares the new HP Officejet Pro 6230 ePrinter with the HP Officejet 6100 ePrinter.



**HP Officejet Pro 6230 ePrinter**



**HP Officejet 6100 ePrinter**

**Benefits**

Up to 18 pages per minute (ppm) black, up to 10 ppm colour print speed (A4) <sup>4</sup>	Up to 16 ppm black, up to 9 ppm colour print speed (A4)	Faster black and colour print speeds help you get more done
Two-sided printing up to 8 images per minute (ipm) black, up to 5 ipm colour (A4) <sup>4</sup>	Not available	Two-sided printing for more productivity
Up to 15,000 page monthly duty cycle <sup>5</sup>	Up to 12,000 page monthly duty cycle	Improved reliability with up to 3,000 more pages
Internal power supply and integrated automatic two-sided printing	Not available	Smaller footprint saves space; reduce paper usage by up to half with automatic two-sided printing

# Top features at a glance

Drive business success with professional colour for up to half the cost per page of lasers.<sup>1</sup> Easily print from all your devices—smartphones, tablets, Internet-connected notebooks, and PCs—across the office or on the go.<sup>2</sup> Save up to 50 percent on paper with automatic two-sided printing.



High-yield ink cartridges

## Professional colour for less than lasers<sup>1</sup>

- Look professional with every page, using Original HP pigment inks for vibrant, durable prints.<sup>6</sup>
- Count on a better value for frequent printing with optional Original HP high-yield individual ink cartridges.<sup>7</sup>
- Set the pace for success—with speeds up to 18 pages per minute (ppm) black and 10 ppm colour.<sup>4</sup>
- Save up to 50 percent on paper with automatic two-sided printing of documents and borderless colour brochures.



Automatic two-sided printing

## Print on your terms

- Easily print documents, photos, and more, wherever business happens—in the office, home, or on the go—with HP Mobile Printing solutions.<sup>2</sup> Learn more at [hp.com/go/mobileprinting](http://hp.com/go/mobileprinting).
- Enable wireless printing from mobile devices without the need for a router or a local network with HP wireless direct printing.<sup>8</sup>
- Connect this ePrinter to your local network and the Internet wirelessly,<sup>9</sup> or with a wired connection using the 10/100 Ethernet port.
- Manage the ePrinter and scan on the go with the free HP All-in-One Printer Remote mobile app.<sup>10</sup>



15,000-page monthly duty cycle

## Productivity features to keep business rolling

- Reload paper less often and handle large print jobs, using the 225-sheet paper tray.
- Depend on a printer with an up to 15,000-page monthly duty cycle.<sup>5</sup>
- Create high-impact materials that dry fast and resist fading for decades.<sup>6</sup> HP recommends ColorLok<sup>®</sup> paper for best printing results.



HP Planet Partners

## Save resources without sacrificing performance

- Save resources with this ENERGY STAR qualified ePrinter and use up to 50 percent less energy than colour lasers.<sup>3</sup>
- Conserve resources—use less supplies and packaging by weight compared with laser printers.<sup>11</sup>
- Manage energy costs with HP Auto-Off Technology.<sup>12</sup>
- Count on easy cartridge recycling at no additional cost through HP Planet Partners.<sup>13</sup>



# Professional colour for less than lasers

Make a professional impression with high-quality colour printing that can get your business noticed—for up to 50 percent less cost per page than lasers.<sup>1</sup> Original HP pigment inks produce vibrant documents that represent your business best.<sup>6</sup> And with fast printing speeds, you can spend less time at your printer and more time focused on your work.

## Professional colour for less than lasers

Make a lasting impression with professional-quality colour printing and keep your budget in check. This versatile ePrinter delivers vivid colour documents, brochures, flyers, and marketing materials for up to 50 percent lower cost per page than lasers.<sup>1</sup>



4 individual inks

### Quality results that last

This ePrinter uses four individual ink cartridges (black, cyan, magenta, and yellow), as well as specially designed print heads, so you replace only the ink cartridge that runs out. Original HP individual ink cartridges deliver consistent, high-quality, fast colour printing. Original HP pigment inks produce vibrant documents that show your business best and resist fading, water, and highlighter smears.<sup>6</sup>

### Added value

Count on a better value for frequent printing with optional Original HP high-capacity individual ink cartridges. HP high-capacity individual ink cartridges allow you to produce up to twice as many pages as standard-capacity HP ink cartridges.<sup>7</sup>



Water-resistant prints

## Speed through document tasks

The HP Officejet Pro 6230 ePrinter delivers black-and-white prints at speeds up to 18 ppm, A4 and colour prints up to 10 ppm, A4.<sup>4</sup>



Automatic two-sided printing

## Easily print on both sides of a page

Help your business attract new customers and save up to 50 percent on paper with integrated automatic two-sided printing of documents and borderless colour marketing materials. Now it's easy to make your business look its best from the convenience of your office.

# Print on your terms

Easily print from all your devices—smartphones, tablets, Internet-connected notebooks, and PCs—in the office or on the go.<sup>2</sup> Connect this ePrinter to your local network and the Internet wirelessly,<sup>9</sup> or with a wired connection using the 10/100 Ethernet port. Print from any desk—it's that easy. Plus, manage this printer from your mobile device, using the free HP All-in-One Printer Remote mobile app.<sup>10</sup>



HP Mobile Printing



Wireless direct



HP ePrint



HP All-in-One Remote app

## Simple mobile printing, wherever business happens

With HP Mobile Printing solutions, your ePrinter is equipped to easily print content from many of today's smartphones and tablets, whether you're at work, home, or on the go.<sup>2</sup> To learn more, visit: [hp.com/go/mobileprinting](http://hp.com/go/mobileprinting).

- HP Slate and many Android OS 4.4 and later devices feature built-in printing via a pre-installed HP Print Service plugin—no software downloads are required.<sup>14</sup> For devices without the pre-installed plugin, visit the Google Play store to download the HP Print Service plugin. If your Android device does not support OS 4.4, download the HP ePrint app from the Google Play store to enable easy mobile printing.<sup>15</sup>
- Print from your iPhone, iPad, and iPod touch using Apple AirPrint—no need to install anything.<sup>16</sup>
- Easily print from HP Windows® 8 notebooks, tablets, and PCs—no software downloads are required.<sup>17</sup>
- No access to a network? No problem. Print wirelessly from smartphones and tablets using HP wireless direct printing.<sup>8</sup> Your ePrinter broadcasts its own Wi-Fi network for mobile devices to connect and send print jobs. This simple printing solution is great for office staff or visitors, when accessing a network is not possible.<sup>8</sup>
- Need to print while away from the office or on the go? Print documents, photos, and more using HP ePrint. Your ePrinter has a unique email address to send print jobs.<sup>18</sup>
- This ePrinter is also Google Cloud Print™ ready, with no need for print drivers or additional software.<sup>19</sup> Simply register with your HP ePrint email address on Google's HP registration page: [google.com/cloudprint/learn/setup-hp.html](http://google.com/cloudprint/learn/setup-hp.html).

## Wireless or Ethernet—you're covered<sup>9</sup>

This ePrinter is designed to be easy to set up and share with a small work team (up to five users). Integrated 802.11b/g/n networking and HP Auto Wireless Connect make it easy to connect the HP Officejet Pro to your wireless network automatically and print wirelessly right away.<sup>20</sup> Built-in Ethernet allows you to connect the device directly to a 10/100 Ethernet network. Either way, you'll enjoy effortless printing from any desk in the office.

## Remote control for your printer

Manage this ePrinter and scan documents directly from your smartphone or tablet, using the free HP All-in-One Printer Remote mobile app.<sup>10</sup> Check ink status, manage documents, and create high-quality documents with the camera-based intelligent mobile scanning feature.<sup>10</sup>

# Productivity features to keep business rolling

Handle large print jobs without slowing down. Grow your business with an ePrinter you can count on to help you print what you need—at fast speeds—and move on to your next important project.



15,000-page monthly duty cycle



Fade-resistant prints

## Increase productivity

- **Turn up the print volume.** Save trips to the supply closet. The 225-sheet paper tray easily handles large copy and print jobs so you can keep your business moving.
- **Performance you can count on.** Depend on a printer with an up to 15,000-page monthly duty cycle—the perfect fit for reliable colour printing.<sup>5</sup>
- **Lock in quality.** HP pigment inks create high-impact materials that dry fast and resist fading for decades.<sup>6</sup> HP recommends ColorLok paper for best printing results.

## Easy-to-use LED control panel

The HP Officejet Pro 6230 ePrinter offers users an easy-to-use LED control panel for quickly adjusting media sizes, assessing ink cartridge life, resuming or cancelling jobs, and accessing HP Mobile Printing and HP ePrint options.

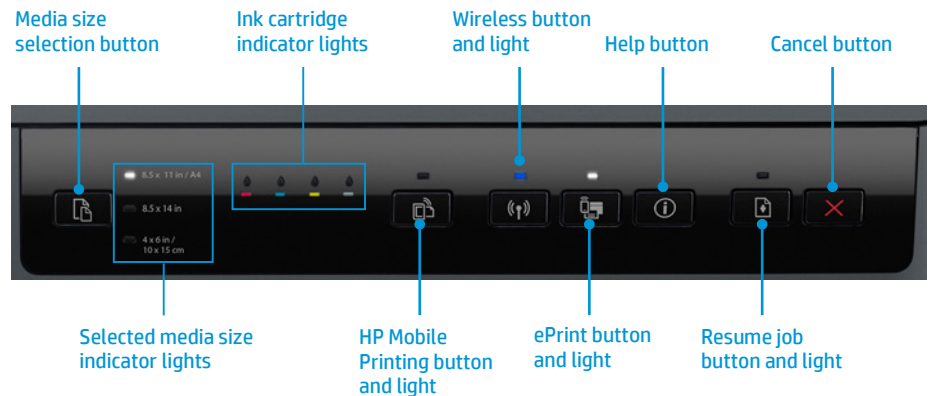

# Save resources without sacrificing performance



Up to 50 percent less  
energy use than laser<sup>3</sup>



HP Planet Partners

It has never been more important to save energy and resources, and HP technologies can help. HP's Design for the Environment initiative is driving improvements at every stage in the product lifecycle—helping reduce the amount of energy, paper, packaging, and materials used at HP and by our customers.

## Conserve resources

With its intelligent design, this HP Officejet Pro ePrinter can help you meet your energy goals and reduce your environmental impact:

- **Reduce energy use.** Save resources with this ENERGY STAR qualified ePrinter and use up to 50 percent less energy than colour lasers.<sup>3</sup>
- **Less weight, less waste.** Use up to 80 percent less supplies and packaging by weight compared with colour lasers.<sup>11</sup>
- **Save energy automatically.** Save energy by presetting your device to turn on when you need it and off when you don't.

## Easy cartridge recycling

Reduce your impact on the environment. Easily recycle your Original HP ink cartridges for free through HP Planet Partners.<sup>13</sup>



## Notes

<sup>1</sup> Cost-per-page (CPP) claim compares the majority of multi-pass colour laser printers <€200 EUR excluding VAT, as of February 2014, based on market share as reported by Q4 2013 IDC. CPP for laser supplies are based on published specifications of the manufacturers' highest-capacity cartridges. HP Officejet Pro CPP based on HP 934XL/935XL ink cartridges estimated street price, published yield and continuous printing. Actual prices may vary. Actual yields may vary based on images printed and other factors. For more information, see [hp.com/go/learnaboutsupplies](http://hp.com/go/learnaboutsupplies).

<sup>2</sup> Local printing requires mobile device and printer to be on the same wireless network or have a direct wireless connection. Wireless performance is dependent on physical environment and distance from access point. Wireless operations are compatible with 2.4 GHz operations only. Remote printing requires an Internet connection to an HP web-connected printer. App or software and HP ePrint account registration may also be required. Wireless broadband use requires separately purchased service contract for mobile devices. Check with service provider for coverage and availability in your area. See [hp.com/go/mobileprinting](http://hp.com/go/mobileprinting) for more details.

<sup>3</sup> Majority of multi-pass colour laser printers <€200 EUR excluding VAT, as of February 2014, based on market share as reported by Q4 2013 IDC; ISO yield with highest-yield cartridges. Energy use is based on internal HP testing. Actual cost and energy usage may vary

<sup>4</sup> After first set of ISO test pages. For more information, see [hp.com/go/printerclaims](http://hp.com/go/printerclaims).

<sup>5</sup> Duty cycle is defined as the maximum number of pages per month of imaged output.

<sup>6</sup> Fade resistance based on paper-industry predictions for acid-free papers and Original HP inks; colourant stability data at room temperature based on similar systems tested per ISO 11798 and ISO 18909. Water resistance based on HP internal testing, using paper with the ColorLok logo.

<sup>7</sup> Based on HP 934XL High Yield Black Original Ink Cartridges and HP 935XL High Yield colour ink cartridges. High-yield ink cartridges not included; purchase separately. For more information, see [hp.com/go/learnaboutsupplies](http://hp.com/go/learnaboutsupplies). Value compared with estimated street price and average page yield of standard-yield HP 934/935 ink cartridges. Actual pricing may vary.

<sup>8</sup> Mobile device must be connected directly to the Wi-Fi network of a wireless direct-capable printer prior to printing. Depending on mobile device, an app or driver may also be required. Wireless performance is dependent on physical environment and distance from the access point in the printer.

<sup>9</sup> Wireless performance is dependent on physical environment and distance from access point. Wireless operations are compatible with 2.4 GHz routers only.

<sup>10</sup> Mobile device requires wireless access point and an Internet connection. Compatible with iPhone 4 and later, iPad 4th generation, iPad mini, iPad Air and iPod 5G using iOS 7 or later, and mobile devices using Android 4.0.x or later. Features controlled may vary by mobile device operating system. Scan/copy control requires mobile device and printer be on the same wireless network or through wireless direct connection to printer. For mobile scanning, device camera requires 5 megapixels or greater with autofocus capability.

<sup>11</sup> Compared with the majority of multi-pass colour laser printers <€200 EUR excluding VAT, as of February 2014, based on market share as reported by Q4 2013 IDC. Calculation compares weight of supplies and cartridge packaging needed for the same amount of pages based on ISO yield and continuous printing.

<sup>12</sup> HP Auto-Off Technology capabilities subject to device and settings.

<sup>13</sup> Program availability varies. Original HP cartridge return and recycling is currently available in more than 49 countries, territories, and regions in Asia, Europe, and North and South America through the HP Planet Partners program. For more information, visit [hp.com/recycle](http://hp.com/recycle).

<sup>14</sup> Solution supported on all HP Slate Android devices, including HP Slate 7, HP Slate 7 HD, HP Slate 7 Extreme, HP Slate 8 Pro, HP Slate 10 HD, and HP Slate 21 AIO.

<sup>15</sup> Supports Samsung devices powered by Android OS 4.1 Jelly Bean or newer, including Samsung Galaxy S4, and HP Slate 7. Requires the printer be connected to the same network as your compatible mobile device. Remote printing requires an Internet connection to an HP web-connected printer, HP ePrint app, and HP ePrint account registration. Wireless performance is dependent on physical environment and distance from the access point. Wireless operations are compatible with 2.4 GHz routers only. Wireless broadband use requires separately purchased service contract for mobile devices. Check with service provider for coverage and availability in your area. See [hp.com/go/mobileprinting](http://hp.com/go/mobileprinting) for more details.

<sup>16</sup> Supports Apple OS X Lion, OS X Mountain Lion, and the following devices running iOS 4.2 or later: iPad (all models), iPhone (3GS or later), and iPod touch (3rd generation or later). Works with HP's AirPrint-enabled printers and requires the printer be connected to the same wireless network as your OS X or iOS device. Performance is dependent on physical environment and distance from the wireless access point. Wireless operations are compatible with 2.4 GHz routers only.

<sup>17</sup> Select drivers on some OS versions may need to be activated before use.

<sup>18</sup> Check your compatible device's official app store for HP ePrint app download availability. Requires an Internet connection to an HP ePrint-enabled printer. Printer requires ePrint account registration. App or software may be required. Wireless operations are compatible with 2.4 GHz operations only. Print times and connection speeds may vary. Wireless broadband use requires separately purchased service contract for mobile devices. Check with service provider for coverage and availability in your area. Learn more at [hp.com/go/mobileprinting](http://hp.com/go/mobileprinting).

<sup>19</sup> Google™ and Gmail are trademarks of Google Inc. Feature requires Google Cloud Print Ready printer or existing printer connected to a PC with Internet access. Print times may vary. Currently only Google apps are supported.

<sup>20</sup> HP Auto Wireless Connect may not be available for all system configurations. Wireless performance is dependent on physical environment and distance from access point. Wireless operations are compatible with 2.4 GHz routers only. For information on compatibility, visit [hp.com/go/wirelessprinting](http://hp.com/go/wirelessprinting).

### Sign up for updates

[hp.com/go/getupdated](http://hp.com/go/getupdated)



Share with colleagues



Rate this document

© Copyright 2014 Hewlett-Packard Development Company, L.P. The information contained herein is subject to change without notice. The only warranties for HP products and services are set forth in the express warranty statements accompanying such products and services. Nothing herein should be construed as constituting an additional warranty. HP shall not be liable for technical or editorial errors or omissions contained herein.

AirPrint and the AirPrint Logo are trademarks of Apple Inc. iPad, iPhone, and iPod touch are trademarks of Apple Inc., registered in the U.S. and other countries. ENERGY STAR and the ENERGY STAR mark are registered U.S. marks. Android, Google, Google Play and Gmail are trademarks of Google, Inc. Windows is a U.S. registered trademark of Microsoft Corporation.



# At a glance

## Main features



Print



Wireless



Print from smartphone and tablet



2-sided printing



Borderless printing



## Highlighted features



Up to 50% lower cost  
Color prints at up to half the cost per page of laser.



HP Smart app  
Manage printing tasks and scan directly from your mobile device.



Wi-Fi Direct  
Print wirelessly from your mobile device, no router or access to local network required.

## Additional features

- LED control panel
- Optional high-yield cartridges
- Ethernet networking
- HP Auto-Off Technology
- ENERGY STAR® certified
- Auto document feeder
- Scan to email

- Included
- Not included

## Ink cartridges

HP 934/935 standard/XL



## In the box



HP OfficeJet Pro 6230 Printer



HP 934/935 Setup Ink Cartridges  
Black, Cyan, Magenta, Yellow



Power cord



User guide  
Setup poster

USB cable not included